



## AirGoggle™ NVC210H Series H.264 Professional Fixed Box IP Video Cameras

AirGoggle NVC210H Series H.264 Professional Fixed Day/Night IP Video Camera uses a dual codec supporting H.264 & Motion JPEG digital video compression standards. The NVC210H is offered in four sub-models based on a combination of day/night and wide dynamic range options to tackle the most demanding IP video applications. When used for outdoor surveillance, a wide selection of complementary camera housing accessories and lenses are available. High performance and reliable design, along with a host of convenient features, makes the AirGoggle™ NVC210H series cameras ideal for indoor or outdoor\* professional security surveillance applications.

Another powerful features include optional flash memory for local storage and multiple simultaneous video streams of differentiated resolutions and frame rates, and these two powerful features will secure video storage if the network becomes unavailable and ensure the highest video quality service while enabling simultaneous connections through lower speed networks.

The NVC210WDH model with wide dynamic range has an added benefit of digital pixel technology. Wide dynamic range tackles severe backlight and glare issues by dynamically compensating contrast to deliver uniform steady clear video images. The digital pixel technology brings true digital performance throughout the entire real-time encoding process from the moment an object is captured through the lens to the encoded images across the network. The synergy of these two enhancement technologies brings forth the best signal to noise and low light sensitivity in its class for the most demanding video surveillance applications.



### KEY FEATURES & BENEFITS

- ▶ **H.264 & MJPEG Dual Codec Operation**  
State of the art H.264 digital video encoding allows for the highest quality D1 video at the lowest bandwidth possible. Motion JPEG (MJPEG) digital still video encoding allows for high quality recording and playback.
- ▶ **Multiprofile Streaming**  
High performance streaming profiles offers 3 streams of different resolution & frame rates providing IP video flexibility for the most demanding IP video applications.
- ▶ **802.3af Power over Ethernet (PoE)**  
Run up to 300 feet or 100 meter of network cable away from the power source with optional 48VDC PoE Injector
- ▶ **Mobile Phone Support**  
Supports the latest iPhone & Android smart phones for real time 24x7 access to the video information most important to you.
- ▶ **Wide Dynamic Video Technology**  
To ensure details of high contrast scenes to appear clear with accurate color in both bright and dark areas simultaneously. The suite of functions from the embedded streaming web server make accessing real-time video easy from any Internet Explorer enabled computer
- ▶ **Synchronized Audio/Video and Two-Way Audio Communication**  
Audio line in and line out interface(s) with software selectable audio feature provides synchronized audio surveillance and announcement capabilities from the monitoring station
- ▶ **Event Driven Real-Time Notification**  
The integrated sensor input, alarm output, and video motion detection provides actionable event trigger functionality able to send a video clip via email or FTP and turn on/off external relays
- ▶ **Embedded Streaming Web Server**  
The suite of functions from the embedded streaming web server make accessing real-time video easy from any Internet Explorer enabled computer
- ▶ **Optional flash memory for local storage**

### APPLICATIONS



#### AIRPORTS

Regardless if it is inside or outside of an airport, Inscape Data offers total wired or wireless IP based video security solutions that will save on your installation cost and make your monitoring more efficient



#### METROPOLITAN STREETS

Inscape Data's wired and wireless IP based video security solutions will save on your installation cost and make the streets and metropolitan safer



#### BUILDINGS

Inscape Data's wired and wireless IP based video security solutions will save on your installation cost and make your buildings more secure



#### SCHOOL CAMPUS

Regardless if it is inside classrooms or on a campus, Inscape Data's wired and wireless IP based video security solutions will save on your installation cost and make monitoring easier

### MODEL SELECTIONS

Model	Color	D/N Day:color Night: Black/White	Wide Dynamic
NVC210H	✓		
NVC210H-DN	✓	✓	
NVC210WDH	✓		✓
NVC210WDH-DN	✓	✓	✓

### SYSTEM CONFIGURATIONS

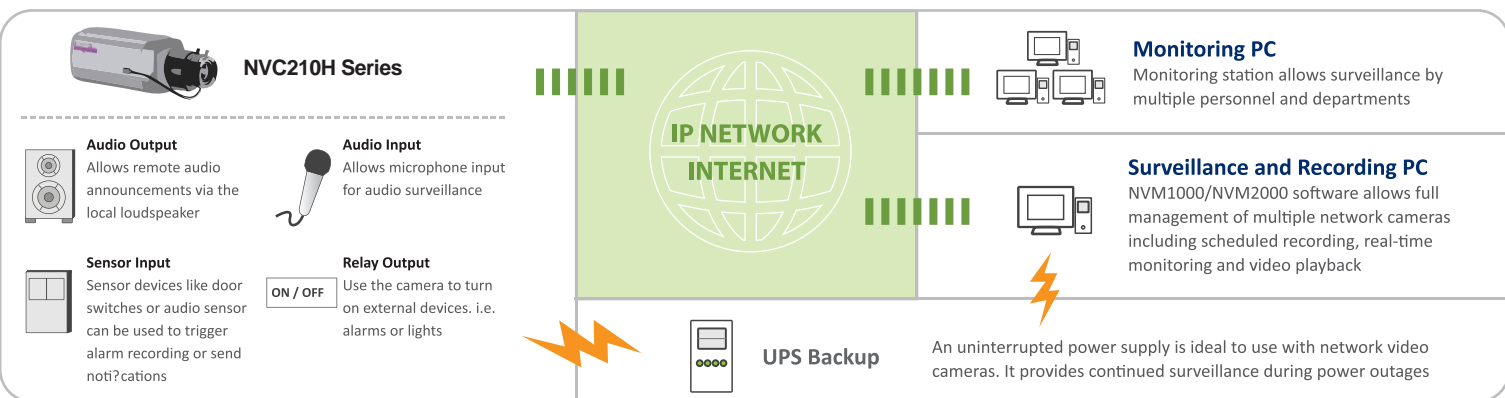

		NVC210H/NVC210H-DN	NVC210WDH/NVC210WDH-DN	
Camera	Image Sensor	1/3" Sony Super HAD CCD	1/3" Pixim Wide Dynamic Range CMOS CB100-TDN3	
	Scanning System	INTERLACE/INTERPOLATE		
	Horizontal resolution	520 Color / 580 Black & White TV Lines	480 TV Lines	
	Lens	DC-Iris Varifocal F1.4 / 3.5-8mm, Removable		
	Horizontal Field of View	80 degrees to 36 degrees		
	Minimum Object Distance	0.1 meter		
	Lens Aperture	1.4		
	Lens Mount	C/CS		
	Lens Iris Support	DC Iris or ELC		
	DC Level Adjustment	32 Level		
	Sharpness	15 Level		
	Day & Night modes (-DN Model Only)	Auto		
	Digital Slow Shutter	ON / OFF		
	Minimum Illumination	0.1 Lux Color / 0.001 Lux B/W 30IRE	0.08 Lux	
	Luminance S/N Ratio	More than 48dB		
	Video Control	Contrast, Brightness, Saturation, Hue		
	Digital Zoom	ON / OFF		
	Auto Gain Control	ON / OFF		
	BLC	ON / OFF		
	Flickerless	ON / OFF		
180 Degree Video Rotation	ENABLE/DISABLE			
Privacy Masking	Yes			
OSD Time Display	ON / OFF 4 Position			
Image (NTSC/PAL)	Compression Format	Dual Codec H.264 & MJPEG Up to 30/25 fps		
	Resolution	NTSC: D1(720x480), Half D1(720x240), CIF (352x240), QCIF (176 x 144) PAL: D1(720x576), Half D1(720x288), CIF(352x288), QCIF(176x144)		
	Maximum Frame Rate	Up to 30/25 at all resolutions Configurable to 1, 4, 8, 15, 20, 30 fps		
	Video Encoding Rates	32kbps ~ 3000 kbps		
Audio	Audio Compression	Upstream: 32kbps G.726 ADPCM Line-In & Mic-In ENABLE/DISABLE		
		Downstream: 128kbps 16-bit Linear PCM - Lin-Out		
Network	Protocols	HTTP, HTTPS, Upnp, SOCKS, TCP/IP v4/v6, RTSP, RTCP, SDP, UDP, IGMP, ICMP, ICMP v6, SMTP, FTP, DHCP, ARP, RARP, DNS, NTP, PPPoE		
	Other network settings	Clone MAC address, HTTP/RTSP Port change		
	Maximum User Access @ Video Rate	40@160kbps, 14@512kbps, 7@1000kbps, 2@3000 kbps		
	Security	Multi-User Viewing Authentication, IP Address filtering, HTTPS Encryption, Digest Authentication, User Access Log		
	Alarm and Event Management	Event Trigger Email, FTP, or Recording Based on Video Motion Detection or External Sensor Input		
	Embedded Web Server	Instant access to live streaming video & full p/t/z functionality via Internet Explorer		
	Data Transmission	Unicast		
	Pre & Post Alarm Recording	5 Seconds		
Interface	Dynamic DNS Management	Supported via free service at mgmt.airgoggle.com		
	Network	10 BaseT / 100BaseTx		
	Serial	RS-485 multiprotocol support for P/T/Z (Pelco D driver loaded)		
	I/O Port(s)	1 sensor input, 1 relay output		
	Audio Line Output	1 port 3.5 mm 3 conductor Mini-jack (tip, ring, sleeve) 0.886Vp-p		
	Audio Line Input	1 port 3.5 mm 3 conductor Mini-jack (tip, ring, sleeve) 1.6Vp-p		
	Microphone	Embedded Microphone Enable or Disable From Software		
	Composite Video Out	2 Pin, Composite (1 V p-p), 75 Ohm		
System Requirements	Power Connector Type	2.5mm Barrel, Center Pin Positive		
	Hardware Reset	Reset Button		
	Operating System	Microsoft Windows 2000 / XP / 2003 / Vista / Windows 7		
	Processor / Memory	CPU: Intel Duo Core / 1GB		
	Network Video Recorder Software - 16 Ch.	CPU: Intel Core i3 / 2GB / 256MB Dedicated Video Memory		
Management	Browser	Microsoft Internet Explorer Ver 7.0 or higher		
	HTTP	Yes		
Environmental	Software	Yes		
	Construction	Body(Aluminum)		
	Camera Dimension(W x H x D) w/o Lens	66 x 58 x 119 mm (2.6" x 2.3" x 4.7" Inches)		
	Lens Dimension	32 x 45.8 x 51mm		
	Weight	510 g (1 lbs)		
	Storage Temperature	-20°C~70°C (-4°F ~158°F)		
	Operating Temperature	0°C~45°C (32°F ~113°F)		
Operating Humidity	8 ~80% RH Non-Condensing			
Power	Outdoor Usage	Recommend Optional Camera Housing with Heater and Blower		
	Power Consumption	10 W		
	Power Supply ( PoE )	802.3af / 48VDC		
Compliance	Power Supply (Local)	12VDC / 1 A		
		<b>FC CE RoHS</b>		

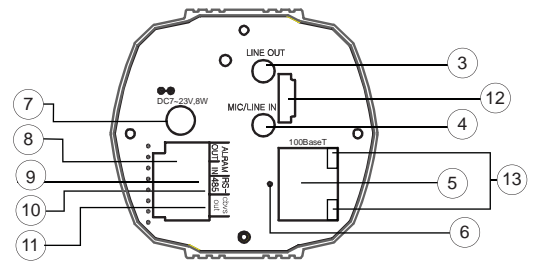
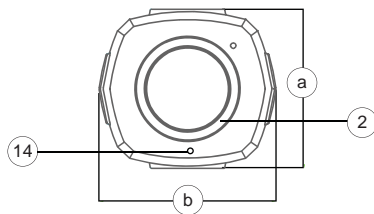
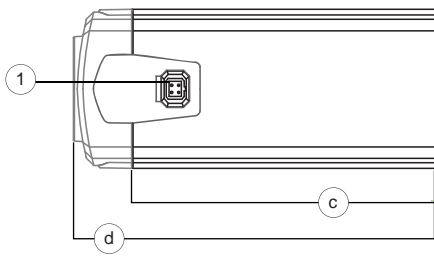

### Camera Dimensions

- a. 57.6mm
- b. 64.0mm
- c. 109.5mm
- d. 137.0mm

### Camera Interfaces and Parts

- 1. Auto Iris Connector
- 2. CS Lens mount ring
- 3. Audio Line Out
- 4. Audio / Mic Line In
- 5. RJ45 Jack
- 6. Hardware reset pin
- 7. Power connector
- 8. Relay Output Connector
- 9. Alarm / Sensor Input Connector
- 10. RS-485 connector
- 11. Composite Video Out
- 12. Not Used
- 13. Network Link/Activity Indicator
- 14. Integrated Mic

### VIDEO ACCESSORIES



**PCHB1300**  
PoE Ready, All Weather  
Cable Management  
Heater & Blower  
-30°C to +60°C  
Camera Housing (CH100HB)  
Housing Bracket (CB300)



**PCHB2200**  
PoE Ready, All Weather  
Standard Encloser  
Heater & Blower  
-30°C to +60°C  
Camera Housing (CH200HB)  
Housing Bracket (CB200)



**PCHB3100**  
PoE Ready, All Weather  
Extended Length for Optional Camera Lens  
Heater & Blower  
-40°C to +60°C  
Camera Housing (CH300HB)  
Housing Bracket (CB100)  
\*Optional Wiper



**PIA100**  
48VDC Integrated PoE Power  
Adapter for NVC210WD

### COMPATIBILITY

1. NVM1000\*



2. NVR100\*



3. NVM2000\*\*



\* Included with purchase  
\*\* Available for purchase

### PACKAGE CONTENTS

- 1. Camera Body
- 2. Lens Auto-Iris Varifocal Lens 3.5 ~ 8mm (CS Mount)
- 3. Lens Adapter C to CS Mount
- 4. DC Iris Lens Connector Kit
- 5. Back Focus Adjustment Wrench
- 6. Switching Power Supply 12VDC 1.5A
- 7. Swivel Arm Surface Mount Bracket with screws
- 8. Product CDROM



THE LEADING  
OUTDOOR NETWORK  
APPLIANCE COMPANY

Total Turnkey Solutions for Outdoor PoE, Wired/Wireless, and IP Video Applications

Product Information Online: <http://www.inscapedata.com/nvc210.htm>

Corporate Headquarters  
1620 Oakland Road, Suite D101, San Jose, CA 95131, U.S.A.  
PHONE +1.408.392.9800 FAX +1.408.392.9812  
EMAIL [sales@inscapedata.com](mailto:sales@inscapedata.com)