

CONTENTS

- | | |
|--------------------------------|---------------------|
| 1. JUNCTION BOX 1EA | 5. CABLE 2EA |
| 2. SET ANCHOR BOLT (W5/16) 4EA | 6. WRENCH (6mm) 1EA |
| 3. M8x25 SCREW 4EA | 7. HARNESS 2EA |
| 4. WASHER 4EA | 8. MANUAL 1EA |

Common Parts

- Put the Cable into the Wall Mount Bracket as FIG.1. (FIG.1)
- Fit the Outdoor Bracket into the groove of the Wall Mount Bracket. (FIG.2)
- Hang the Safety Wire 1 of the Outdoor Bracket up in the Wall Mount Bracket and tighten them up with Screw M4 X 10. (FIG.3)

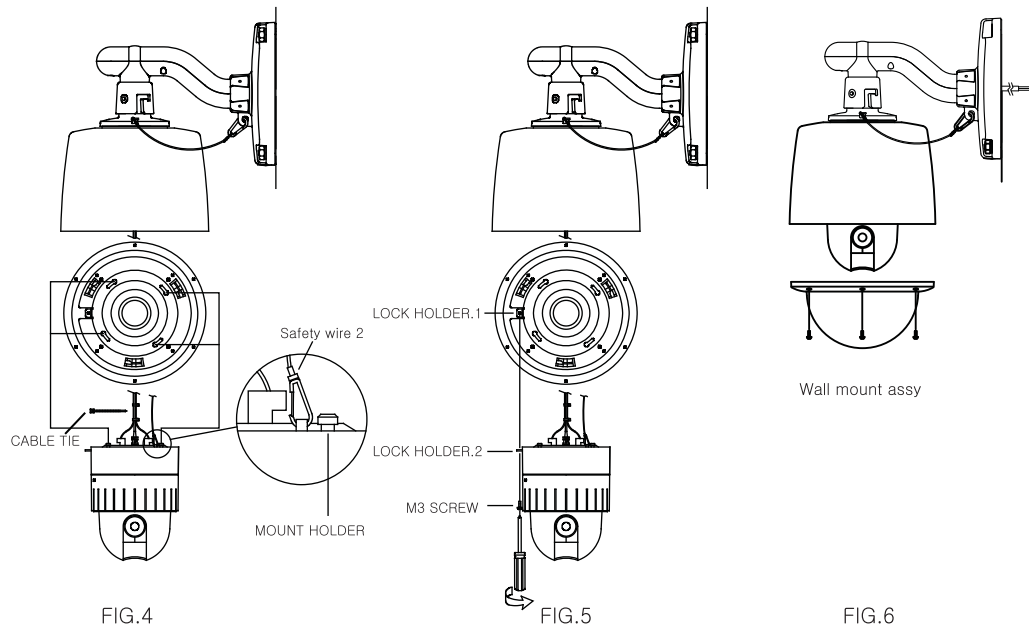
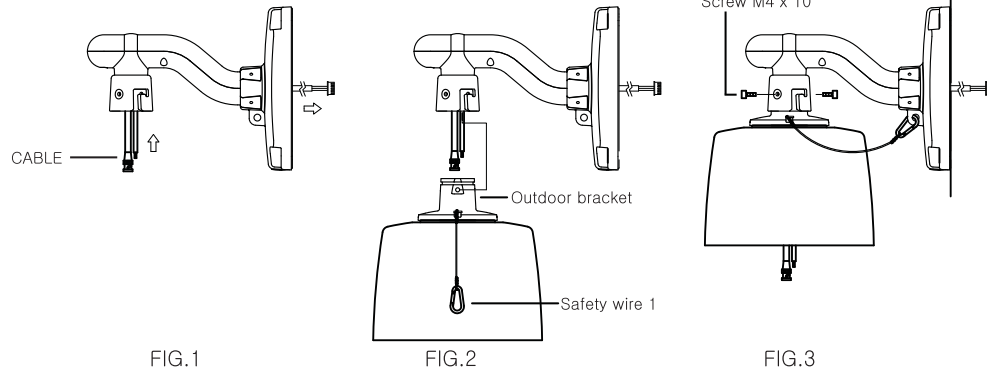

- Hang the Safety Wire 2 of the Outdoor Housing up in the Camera. You can make wires simple by cable ties. (FIG.4)
- Insert mount holder and twist the camera counterclockwise. Place the Camera Mount Holder on the Bracket Mount Hole. To insert them easily, keep 10° interval of Lock Holder1 and Lock Holder2. (FIG.4)
- Screw up Lock Holders with screws. (FIG.5)
- Screw up the bubble tightly to prevent water leakage. (FIG.6)
- Connect the power of Adaptor and assemble the Plate. (FIG.7)

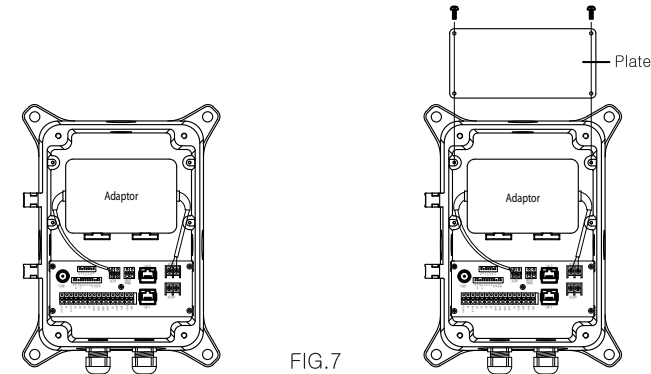

A. Install on a wall

- If you want to install the speed dome on the concrete wall, you need to make 13mm diameter 4 holes by drill like FIG. 8 (Depth 37mm) (FIG.8)
- Install SET ANCHOR BOLT on the holes.
- Fix SET ANCHOR BOLT SET of the bracket by nut. (FIG.9)
- Fit the Wall Mount Bracket Assy into the Junction Box as FIG.8 and fix them with Screw M5 X 100 and close it up with the Cap Bolt. (FIG.10)
- Put the Junction Box and the Wall Mount Bracket together with Screw M8x25. (FIG.11)

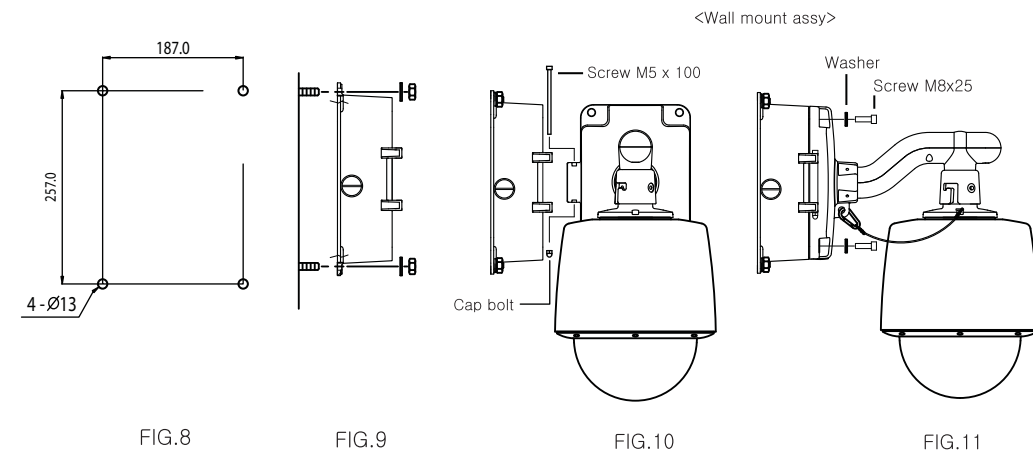

B. Install on a pole mount

- b-1. Fix the wanted bracket on the pole mount bracket with 4 ea of M10 BOLT before you install the pole mount bracket. (FIG.12)
- b-2. Tie the bracket with SUS BAND tightly. (FIG.13)
- b-3. Fit the Wall Mount Bracket Assy into the Junction Box as FIG.8 and fix them with Screw M5 X 100 and close it up with the Cap Bolt. (FIG.14)
- b-4. Put the Junction Box and the Wall Mount Bracket together with Screw M8x25. (FIG.15)

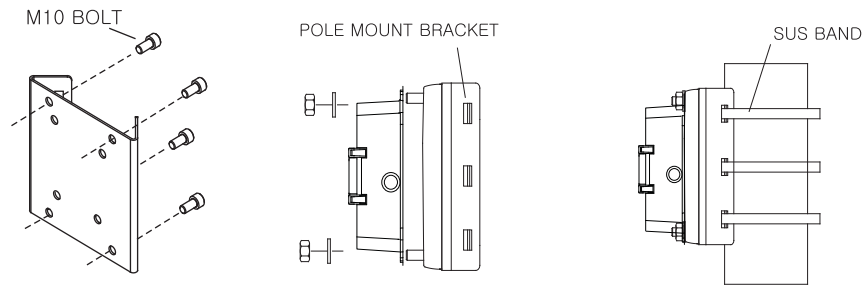

FIG.12

FIG.13

<pole mount assy>

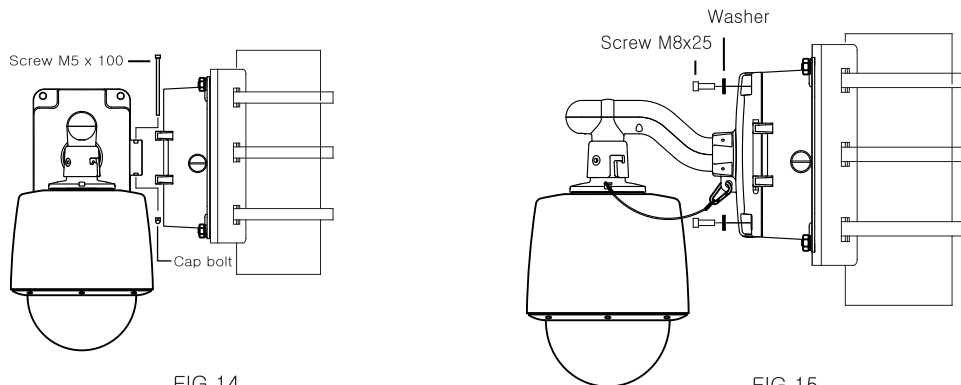

FIG.14

FIG.15

C. Install on a corner mount

- c-1. First mark the positions of holes placing the corner mount bracket.
- c-2. Make $\Phi 13\text{mm}$ 4 holes by drill. (Depth 37mm) (FIG.16)
- c-3. Install SET ANCHOR BOLT on the holes.(FIG.17)
- c-4. Fix the wanted Junction box on the corner mount bracket with 4 ea of M10 BOLT before you install the corner mount bracket. Screw the set anchor bolt of the bracket by nut on the wall. (FIG.18)
- c-5. Fit the Wall Mount Bracket Assy into the Junction Box as FIG.19 and fix them with Screw M5 X 100 and close it up with the Cap Bolt. (FIG.19)
- c-6. Put the Junction Box and the Wall Mount Bracket together with Screw M8x25. (FIG.20)

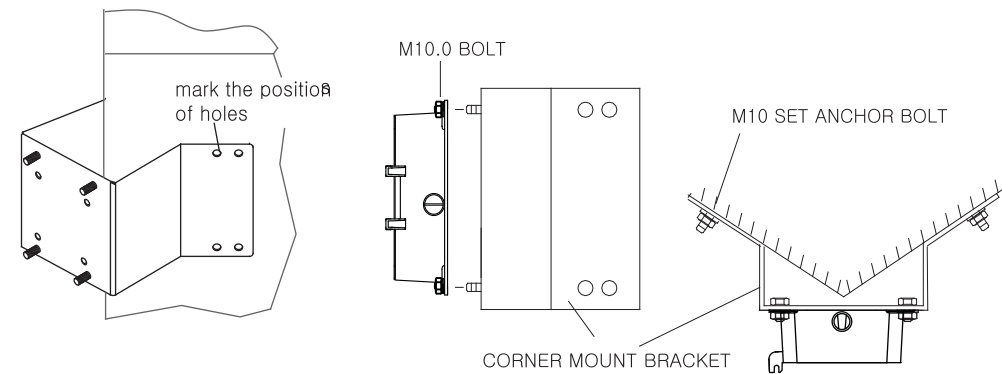

FIG.16

FIG.17

FIG.18

<corner mount assy>

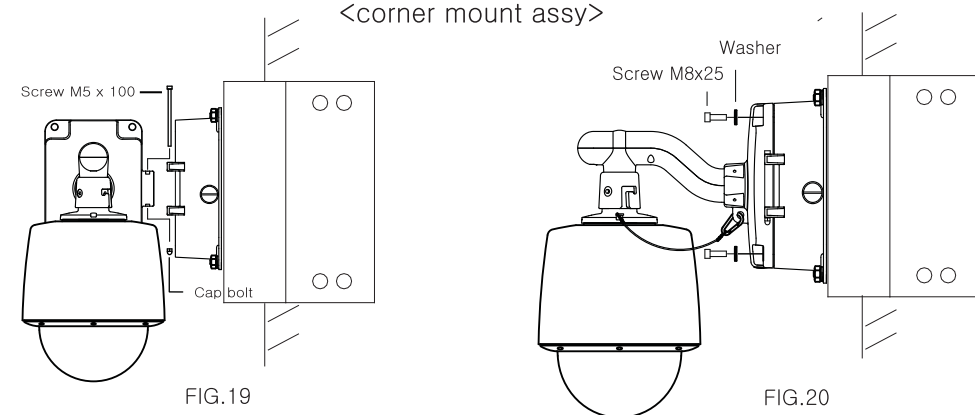
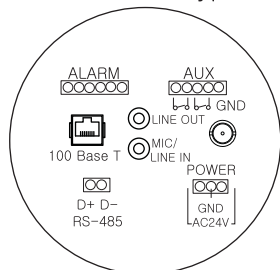

FIG.19

FIG.20

CAMERA REAR PART

1. Network type



2. Analog type

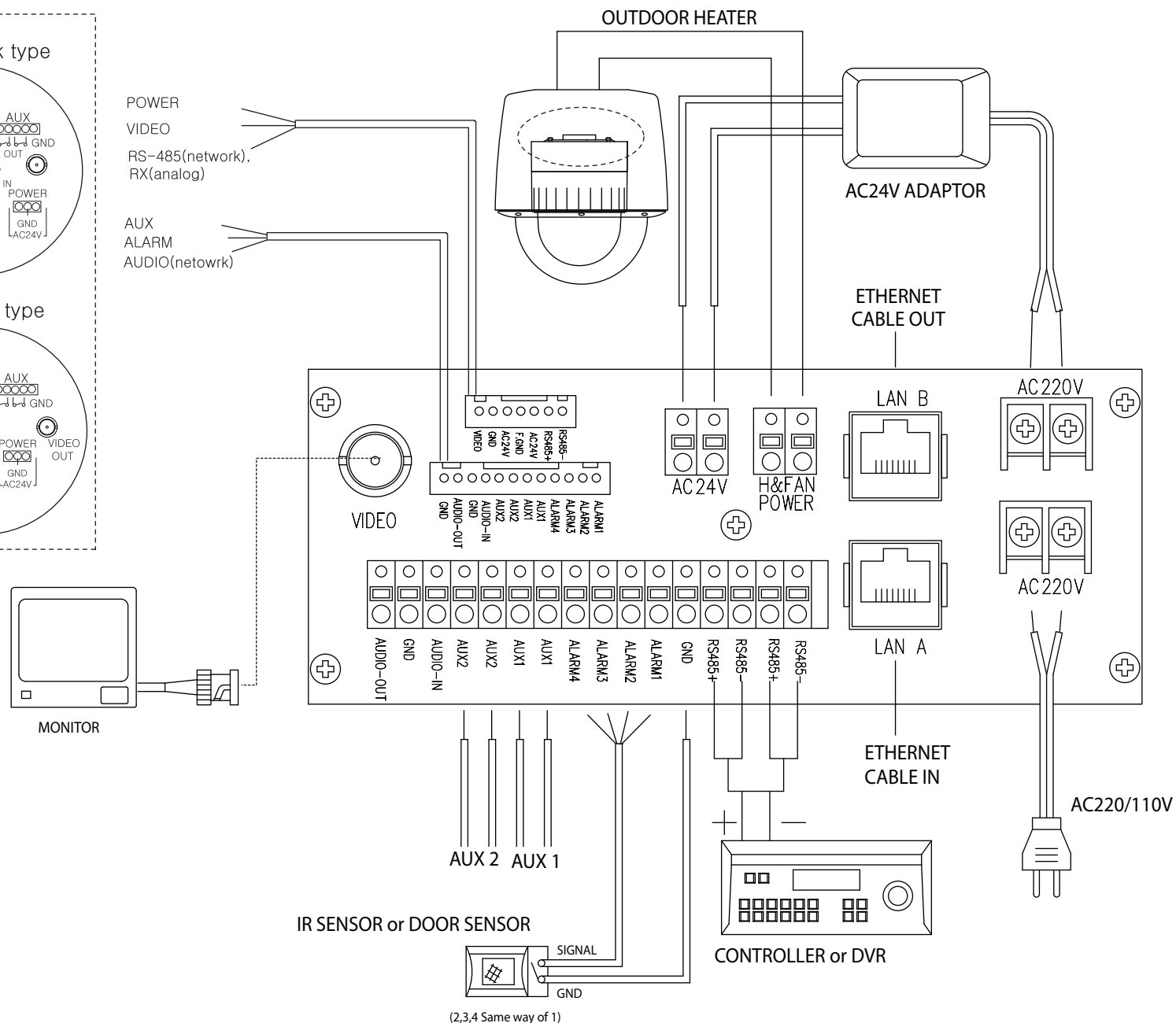
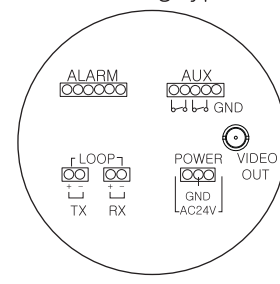

(2,3,4 Same way of 1)