

CONTENTS

- | | |
|--------------------------------|---------------------|
| 1. JUNCTION BOX 1EA | 5. WRENCH (6mm) 1EA |
| 2. SET ANCHOR BOLT (W5/16) 4EA | 6. MANUAL 1EA |
| 3. M8x25 SCREW 4EA | |
| 4. WASHER 4EA | |

Common Parts

1. Put the Cable into the Wall Mount Bracket as FIG.1. (FIG.1)
2. Fit the Outdoor Bracket into the groove of the Wall Mount Bracket. (FIG.2)
3. Hang the Safety Wire 1 of the Outdoor Bracket up in the Wall Mount Bracket and tighten them up with Screw M4 X 10. (FIG.3)

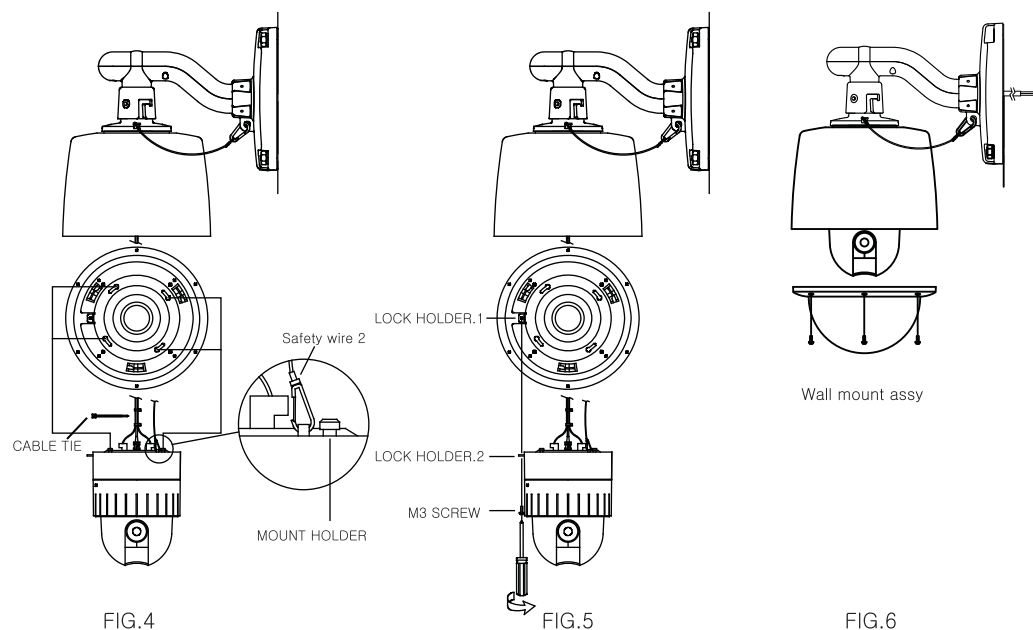
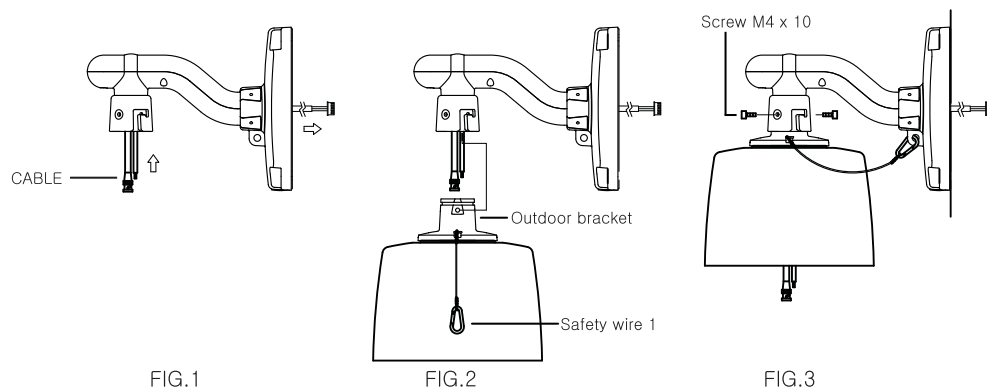

4. Hang the Safety Wire 2 of the Outdoor Housing up in the Camera.
- You can make wires simple by cable ties. (FIG.4)
5. Insert mount holder and twist the camera counterclockwise.
- Place the Camera Mount Holder on the Bracket Mount Hole.
- To insert them easily, keep 10° interval of Lock Holder1 and Lock Holder2. (FIG.4)
6. Screw up Lock Holders with screws. (FIG.5)
7. Screw up the bubble tightly to prevent water leakage. (FIG.6)

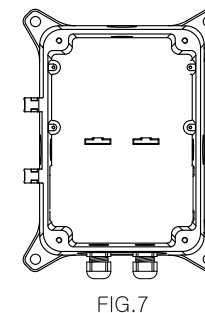

A. Install on a wall

- a-1. If you want to install the speed dome on the concrete wall, you need to make 13mm diameter 4 holes by drill like FIG. 8 (Depth 37mm) (FIG.8)
- a-2. Install SET ANCHOR BOLT on the holes.
- a-3. Fix SET ANCHOR BOLT SET of the bracket by nut. (FIG.9)
- a-4. Fit the Wall Mount Bracket Assy into the Junction Box as FIG.8 and fix them with Screw M5 X 100 and close it up with the Cap Bolt. (FIG.10)
- a-5. Put the Junction Box and the Wall Mount Bracket together with Screw M8x25. (FIG.11)

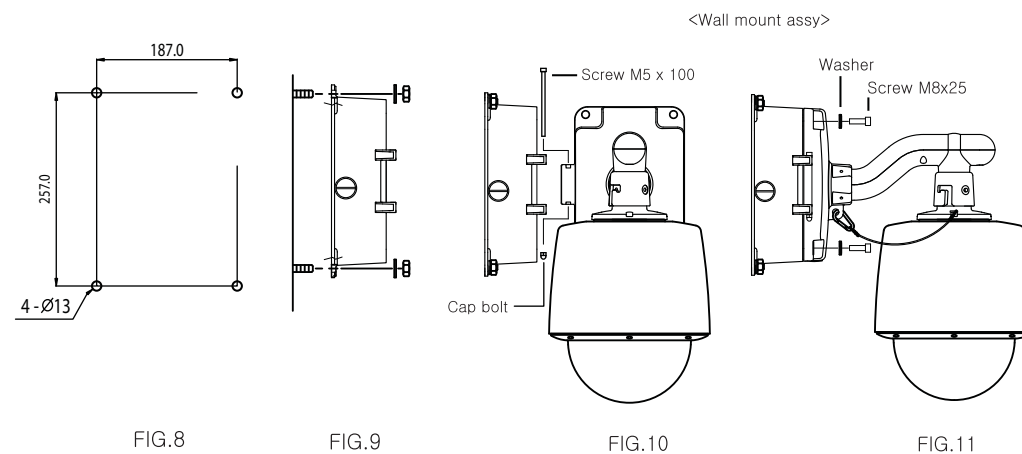

CONTENTS

- | | |
|--------------------------------|---------------------|
| 1. JUNCTION BOX 1EA | 5. WRENCH (6mm) 1EA |
| 2. SET ANCHOR BOLT (W5/16) 4EA | 6. MANUAL 1EA |
| 3. M8x25 SCREW 4EA | |
| 4. WASHER 4EA | |

B. Install on a pole mount

- b-1. Fix the wanted bracket on the pole mount bracket with 4 ea of M10 BOLT before you install the pole mount bracket. (FIG.12)
- b-2. Tie the bracket with SUS BAND tightly. (FIG.13)
- b-3. Fit the Wall Mount Bracket Assy into the Junction Box as FIG.8 and fix them with Screw M5 X 100 and close it up with the Cap Bolt. (FIG.14)
- b-4. Put the Junction Box and the Wall Mount Bracket together with Screw M8x25. (FIG.15)

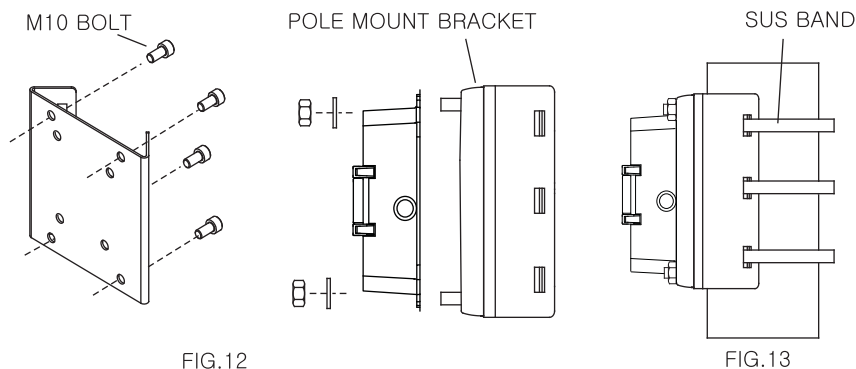

<pole mount assy>

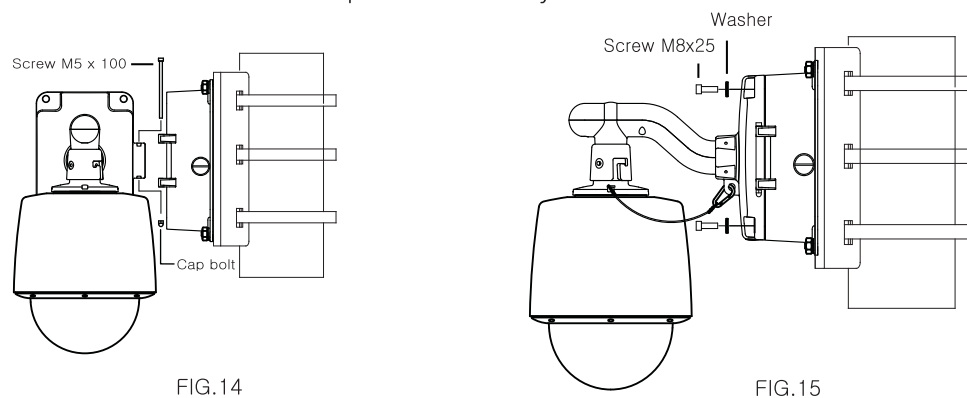

C. Install on a corner mount

- c-1. First mark the positions of holes placing the corner mount bracket.
- c-2. Make $\Phi 13\text{mm}$ 4 holes by drill. (Depth 37mm) (FIG.16)
- c-3. Install SET ANCHOR BOLT on the holes.(FIG.17)
- c-4. Fix the wanted Junction box on the corner mount bracket with 4 ea of M10 BOLT before you install the corner mount bracket. Screw the set anchor bolt of the bracket by nut on the wall. (FIG.18)
- c-5. Fit the Wall Mount Bracket Assy into the Junction Box as FIG.19 and fix them with Screw M5 X 100 and close it up with the Cap Bolt. (FIG.19)
- c-6. Put the Junction Box and the Wall Mount Bracket together with Screw M8x25. (FIG.20)

