



AirGoggle™ NVC210H Series H.264 Professional Fixed Box IP Video Cameras

AirGoggle NVC210H Series H.264 Professional Fixed Day/Night IP Video Camera uses a dual codec supporting H.264 & Motion JPEG digital video compression standards. The NVC210H is offered in four sub-models based on a combination of day/night and wide dynamic range options to tackle the most demanding IP video applications. When used for outdoor surveillance, a wide selection of complementary camera housing accessories and lenses are available. High performance and reliable design, along with a host of convenient features, makes the AirGoggle™ NVC210H series cameras ideal for indoor or outdoor* professional security surveillance applications.

Another powerful features include optional flash memory for local storage and multiple simultaneous video streams of differentiated resolutions and frame rates, and these two powerful features will secure video storage if the network becomes unavailable and ensure the highest video quality service while enabling simultaneous connections through lower speed networks.

The NVC210WDH model with wide dynamic range has an added benefit of digital pixel technology. Wide dynamic range tackles severe backlight and glare issues by dynamically compensating contrast to deliver uniform steady clear video images. The digital pixel technology brings true digital performance throughout the entire real-time encoding process from the moment an object is captured through the lens to the encoded images across the network. The synergy of these two enhancement technologies brings forth the best signal to noise and low light sensitivity in its class for the most demanding video surveillance applications.



KEY FEATURES & BENEFITS

- ▶ **H.264 & MJPEG Dual Codec Operation**
State of the art H.264 digital video encoding allows for the highest quality D1 video at the lowest bandwidth possible. Motion JPEG (MJPEG) digital still video encoding allows for high quality recording and playback.
- ▶ **Multiprofile Streaming**
High performance streaming profiles offers 3 streams of different resolution & frame rates providing IP video flexibility for the most demanding IP video applications.
- ▶ **802.3af Power over Ethernet (PoE)**
Run up to 300 feet or 100 meter of network cable away from the power source with optional 48VDC PoE Injector
- ▶ **Mobile Phone Support**
Supports the latest iPhone & Android smart phones for real time 24x7 access to the video information most important to you.
- ▶ **Wide Dynamic Video Technology**
To ensure details of high contrast scenes to appear clear with accurate color in both bright and dark areas simultaneously. The suite of functions from the embedded streaming web server make accessing real-time video easy from any Internet Explorer enabled computer
- ▶ **Synchronized Audio/Video and Two-Way Audio Communication**
Audio line in and line out interface(s) with software selectable audio feature provides synchronized audio surveillance and announcement capabilities from the monitoring station
- ▶ **Event Driven Real-Time Notification**
The integrated sensor input, alarm output, and video motion detection provides actionable event trigger functionality able to send a video clip via email or FTP and turn on/off external relays
- ▶ **Embedded Streaming Web Server**
The suite of functions from the embedded streaming web server make accessing real-time video easy from any Internet Explorer enabled computer
- ▶ **Optional flash memory for local storage**

APPLICATIONS



AIRPORTS

Regardless if it is inside or outside of an airport, Inscape Data offers total wired or wireless IP based video security solutions that will save on your installation cost and make your monitoring more efficient



METROPOLITAN STREETS

Inscape Data's wired and wireless IP based video security solutions will save on your installation cost and make the streets and metropolitan safer



BUILDINGS

Inscape Data's wired and wireless IP based video security solutions will save on your installation cost and make your buildings more secure



SCHOOL CAMPUS

Regardless if it is inside classrooms or on a campus, Inscape Data's wired and wireless IP based video security solutions will save on your installation cost and make monitoring easier

MODEL SELECTIONS

| Model | Color | D/N Day:color Night: Black/White | Wide Dynamic |
|--------------|-------|--|-----------------|
| NVC210H | ✓ | | |
| NVC210H-DN | ✓ | ✓ | |
| NVC210WDH | ✓ | | ✓ |
| NVC210WDH-DN | ✓ | ✓ | ✓ |

SYSTEM CONFIGURATIONS

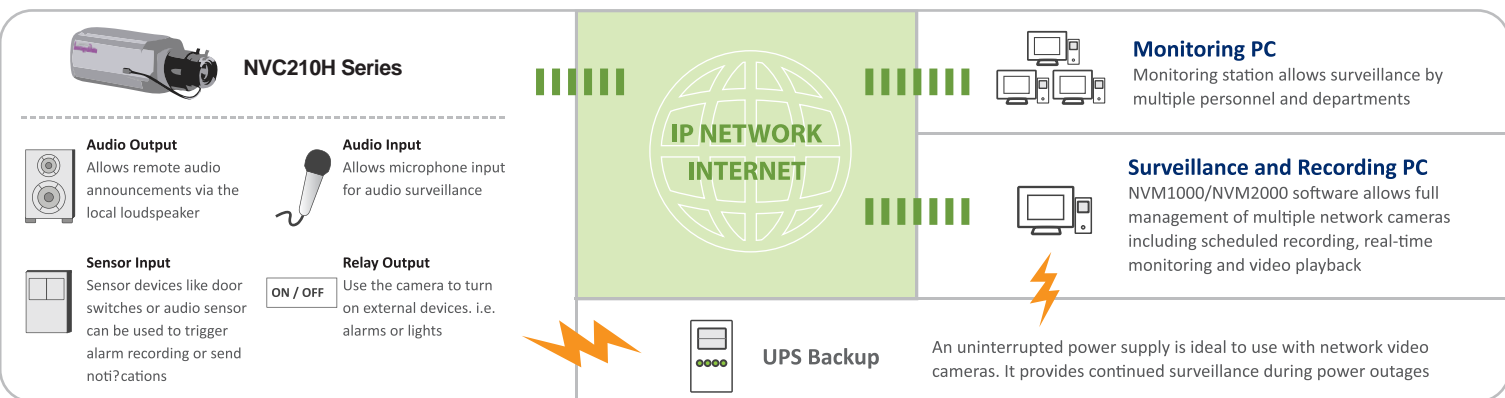

| | | NVC210H/NVC210H-DN | NVC210WDH/NVC210WDH-DN | |
|---------------------|--|---|---|--|
| Camera | Image Sensor | 1/3" Sony Super HAD CCD | 1/3" Pixim Wide Dynamic Range CMOS CB100-TDN3 | |
| | Scanning System | INTERLACE/INTERPOLATE | | |
| | Horizontal resolution | 520 Color / 580 Black & White TV Lines | 480 TV Lines | |
| | Lens | DC-Iris Varifocal F1.4 / 3.5-8mm, Removable | | |
| | Horizontal Field of View | 80 degrees to 36 degrees | | |
| | Minimum Object Distance | 0.1 meter | | |
| | Lens Aperture | 1.4 | | |
| | Lens Mount | C/CS | | |
| | Lens Iris Support | DC Iris or ELC | | |
| | DC Level Adjustment | 32 Level | | |
| | Sharpness | 15 Level | | |
| | Day & Night modes (-DN Model Only) | Auto | | |
| | Digital Slow Shutter | ON / OFF | | |
| | Minimum Illumination | 0.1 Lux Color / 0.001 Lux B/W 30IRE | 0.08 Lux | |
| | Luminance S/N Ratio | More than 48dB | | |
| | Video Control | Contrast, Brightness, Saturation, Hue | | |
| | Digital Zoom | ON / OFF | | |
| | Auto Gain Control | ON / OFF | | |
| | BLC | ON / OFF | | |
| | Flickerless | ON / OFF | | |
| | 180 Degree Video Rotation | ENABLE/DISABLE | | |
| Privacy Masking | Yes | | | |
| OSD Time Display | ON / OFF 4 Position | | | |
| Image (NTSC/PAL) | Compression Format | Dual Codec H.264 & MJPEG Up to 30/25 fps | | |
| | Resolution | NTSC: D1(720x480), Half D1(720x240), CIF (352x240), QCIF (176 x 144) PAL: D1(720x576), Half D1(720x288), CIF(352x288), QCIF(176x144) | | |
| | Maximum Frame Rate | Up to 30/25 at all resolutions Configurable to 1, 4, 8, 15, 20, 30 fps | | |
| | Video Encoding Rates | 32kbps ~ 3000 kbps | | |
| Audio | Audio Compression | Upstream: 32kbps G.726 ADPCM Line-In & Mic-In ENABLE/DISABLE | | |
| | | Downstream: 128kbps 16-bit Linear PCM - Lin-Out | | |
| Network | Protocols | HTTP, HTTPS, Upnp, SOCKS, TCP/IP v4/v6, RTSP, RTCP, SDP, UDP, IGMP, ICMP, ICMP v6, SMTP, FTP, DHCP, ARP, RARP, DNS, NTP, PPPoE | | |
| | Other network settings | Clone MAC address, HTTP/RTSP Port change | | |
| | Maximum User Access @ Video Rate | 40@160kbps, 14@512kbps, 7@1000kbps, 2@3000 kbps | | |
| | Security | Multi-User Viewing Authentication, IP Address filtering, HTTPS Encryption, Digest Authentication, User Access Log | | |
| | Alarm and Event Management | Event Trigger Email, FTP, or Recording Based on Video Motion Detection or External Sensor Input | | |
| | Embedded Web Server | Instant access to live streaming video & full p/t/z functionality via Internet Explorer | | |
| | Data Transmission | Unicast | | |
| | Pre & Post Alarm Recording | 5 Seconds | | |
| Interface | Dynamic DNS Management | Supported via free service at mgmt.airgoggle.com | | |
| | Network | 10 BaseT / 100BaseTx | | |
| | Serial | RS-485 multiprotocol support for P/T/Z (Pelco D driver loaded) | | |
| | I/O Port(s) | 1 sensor input, 1 relay output | | |
| | Audio Line Output | 1 port 3.5 mm 3 conductor Mini-jack (tip, ring, sleeve) 0.886Vp-p | | |
| | Audio Line Input | 1 port 3.5 mm 3 conductor Mini-jack (tip, ring, sleeve) 1.6Vp-p | | |
| | Microphone | Embedded Microphone Enable or Disable From Software | | |
| | Composite Video Out | 2 Pin, Composite (1 V p-p), 75 Ohm | | |
| System Requirements | Power Connector Type | 2.5mm Barrel, Center Pin Positive | | |
| | Hardware Reset | Reset Button | | |
| | Operating System | Microsoft Windows 2000 / XP / 2003 / Vista / Windows 7 | | |
| | Processor / Memory | CPU: Intel Duo Core / 1GB | | |
| | Network Video Recorder Software - 16 Ch. | CPU: Intel Core i3 / 2GB / 256MB Dedicated Video Memory | | |
| Management | Browser | Microsoft Internet Explorer Ver 7.0 or higher | | |
| | HTTP | Yes | | |
| Environmental | Software | Yes | | |
| | Construction | Body(Aluminum) | | |
| | Camera Dimension(W x H x D) w/o Lens | 66 x 58 x 119 mm (2.6" x 2.3" x 4.7" Inches) | | |
| | Lens Dimension | 32 x 45.8 x 51mm | | |
| | Weight | 510 g (1 lbs) | | |
| | Storage Temperature | -20°C~70°C (-4°F ~158°F) | | |
| | Operating Temperature | 0°C~45°C (32°F ~113°F) | | |
| Power | Operating Humidity | 8 ~80% RH Non-Condensing | | |
| | Outdoor Usage | Recommend Optional Camera Housing with Heater and Blower | | |
| | Power Consumption | 10 W | | |
| Compliance | Power Supply (PoE) | 802.3af / 48VDC | | |
| | Power Supply (Local) | 12VDC / 1 A | | |



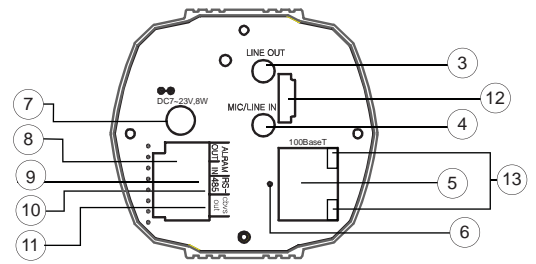
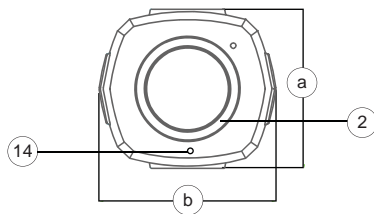
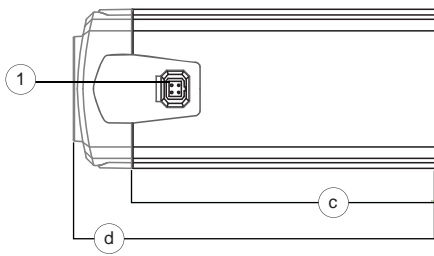

Camera Dimensions

- a. 57.6mm
- b. 64.0mm
- c. 109.5mm
- d. 137.0mm

Camera Interfaces and Parts

- 1. Auto Iris Connector
- 2. CS Lens mount ring
- 3. Audio Line Out
- 4. Audio / Mic Line In
- 5. RJ45 Jack
- 6. Hardware reset pin
- 7. Power connector
- 8. Relay Output Connector
- 9. Alarm / Sensor Input Connector
- 10. RS-485 connector
- 11. Composite Video Out
- 12. Not Used
- 13. Network Link/Activity Indicator
- 14. Integrated Mic

VIDEO ACCESSORIES



PCHB1300
PoE Ready, All Weather
Cable Management
Heater & Blower
-30°C to +60°C
Camera Housing (CH100HB)
Housing Bracket (CB300)



PCHB2200
PoE Ready, All Weather
Standard Encloser
Heater & Blower
-30°C to +60°C
Camera Housing (CH200HB)
Housing Bracket (CB200)



PCHB3100
PoE Ready, All Weather
Extended Length for Optional Camera Lens
Heater & Blower
-40°C to +60°C
Camera Housing (CH300HB)
Housing Bracket (CB100)
*Optional Wiper



PIA100
48VDC Integrated PoE Power
Adapter for NVC210WD

COMPATIBILITY

1. NVM1000*



2. NVR100*



3. NVM2000**



* Included with purchase
** Available for purchase

PACKAGE CONTENTS

1. Camera Body
2. Lens Auto-Iris Varifocal Lens 3.5 ~ 8mm (CS Mount)
3. Lens Adapter C to CS Mount
4. DC Iris Lens Connector Kit
5. Back Focus Adjustment Wrench
6. Switching Power Supply 12VDC 1.5A
7. Swivel Arm Surface Mount Bracket with screws
8. Product CDROM



THE LEADING
OUTDOOR NETWORK
APPLIANCE COMPANY

Total Turnkey Solutions for Outdoor PoE, Wired/Wireless, and IP Video Applications

Product Information Online: <http://www.inscapedata.com/nvc210.htm>

Corporate Headquarters
1620 Oakland Road, Suite D101, San Jose, CA 95131, U.S.A.
PHONE +1.408.392.9800 FAX +1.408.392.9812
EMAIL sales@inscapedata.com